

**CITY OF NAPOLEON
BUILDING CONSTRUCTION PERMIT
(1, 2 or 3 Family Dwelling)**

Owner Name Richard Hatcher
 Address 1125 Sycamore Drive
 Builder Name Self
 Address Same Tel. 599-9901

Lot Information:

Street No. 1125 Sycamore Drive
 Lot 31.32.33 Subdivision Maestric Heights
 Lot Dimensions 75' x 100' Lot Area 7,500 Sq. Ft.
 Yard Set Back: Front Conform to Ord. 11.1.1.1. WA Rear 15'
 Each Side 5' Total Side Min. 15'

Zoning "A" Intended use of Building: Storage & Tool shed 12' x 10'

Building Information:

Single Double Multiple Multiple New Construction X Addition --- Remodel ---
 Size: Length 120' Width 10' No. of Stories 1
 Floor Area: 1st Floor 120' 2nd Floor --- 3rd Floor --- Basement ---
 Unfinished Attic --- Garage ---
 Foundation: Piers --- Full Basement --- Part Basement ---
 Concrete Slab Block ---
 Walls: Frame X Block --- Brick --- Other ---
 Electrical: Wiring --- Electric Heating --- Electrical Appliances ---
 Plumbing: Fixtures or Traps --- Warm Air Heating --- Hot Water Heating ---
 Additional Information: ---

Date 5-6-76 Applicant Signature Richard Hatcher Owner - Builder - Agent

Inspection Record:

Work Started 5/12/76 Foundations --- Plumbing, Heating ---
 Set Back, Side Lines OK Plumbing (Rough In) --- And Air Conditioning ---
 Excavation --- Erecting Frame --- Roof ---
 Footing --- Electrical Work ---

Comments: ---

Certificate of Occupancy Issued --- Pink - Engineer Inspector

Permit No. 510-76
 Issued May 5, 1976
 By Thomas J. Johnson Building Inspector
 Valuation \$600.00

Fees	Base	Plus	Total
Construction	\$3.00	---	\$3.00
Plumbing	---	---	---
Electrical	---	---	---
Heating	---	---	---
Water Tap	---	---	---
Sewer Tap	---	---	---
Temporary Elec.	---	---	---
TOTAL	\$3.00	---	\$3.00

CITY OF NAPOLEON

ZONING PERMIT

Zoning Permit No. 510-76

Issued May 5, 1976

By Richard Hatcher
Zoning Inspector

Filing Fee none Amount none Date Paid none

Issued To: Richard Hatcher

Lot Information:

Street Address 1125 Sycamore Drive

Lot No. 31, 32, 33 Subdivision Majestic Heights

(or Legal Description)
CONTOUR CO
Dist. "A"

Lot Dimensions 75' x 100' Yard Set Back: Front _____ Rear Min. 15'

Lot Area 7,500 Sq. Ft. Each Side 5' Total Side Min. 15'

Zoning District "A" Description of Use Storage & Tool Shed 12' x 10'

Lot Coverage Max. 35% OK Off Street Parking Spaces Required Two (2) OK

Height Max. 18' Loading Spaces Required None

Petition or Appeal Required None

Approved By: Zoning Inspector Yes Board of Zoning Appeals _____

Date 5-6-76 Applicant Signature Richard Hatcher Owner-Agent _____

White--Applicant Yellow - Clerk-Treasurer Pink-Engineering Gold - Board of Zoning Appeals

CITY OF NAPLES
ENGINEERING DEPARTMENT
APPLICATION FOR CONSTRUCTION PERMIT
PLEASE PRINT OR TYPE

The undersigned hereby makes application for the construction, installation, replacement or alteration as herein specified, agreeing to do all such work in strict accordance with the City of Naples's Building Code for 1, 2 and 3 Family Buildings.

Owner's Name x Richard Hatcher Address x 1125 Sycamore Lane
 Builder's Name x Richard Hatcher Address x 1125 Sycamore Tel x 599-9901

LOT INFORMATION: (Not required for roofing or siding job.)
 Location of Project: _____ Lot # 31-32-33

Subdivision _____
 Yard Set Back: Front _____ Rear min 5'
 Right Side _____ Left Side _____
 Zoning District "R"
 Lot Area x 7500 Sq. Ft.

BUILDING INFORMATION:

Single _____ Double _____ Multiple _____ New Construction _____
 Addition _____ Remodel _____ Attached Garage _____
 Detached Garage _____ Accessory Building _____ Replacement _____

Brief Description of Work: x Poor Concrete Slab for building

Size: Length x 12' Width x 10' No. of Stories x 1

Floor Area: 1st Floor _____ Sq. Ft. 2nd Floor _____ Sq. Ft.
 3rd Floor _____ Sq. Ft. Basement _____ Sq. Ft.
 Unfinished Attic _____ Garage _____

x Foundation: Piers _____ Full Basement _____ Part Basement _____
 Concrete 4" Thickness Block _____ Size _____

x Walls: Frame ✓ Block _____ Brick _____ Other _____
 Specific Type of Exterior Siding x Wood

APPLICATION FOR PERMIT SHALL BE ACCOMPANIED BY TWO COMPLETE SETS OF PLANS INCLUDING: ELEVATIONS, FLOOR PLANS, CROSS SECTIONS AND PLOT PLAN. ADDITIONS OR REMODELING, SHOW ALL EXISTING STRUCTURES AND THEIR EXACT LOCATION. ALL PLANS SHALL BE DRAWN TO 1/8"=1'-0" SCALE. PLAN TO 1/8"=1'-0" SCALE.

ESTIMATED COST OF COMPLETED PROJECT x \$ 600.00

DATE x 5/5/76 APPLICANT'S SIGNATURE x Richard Hatcher

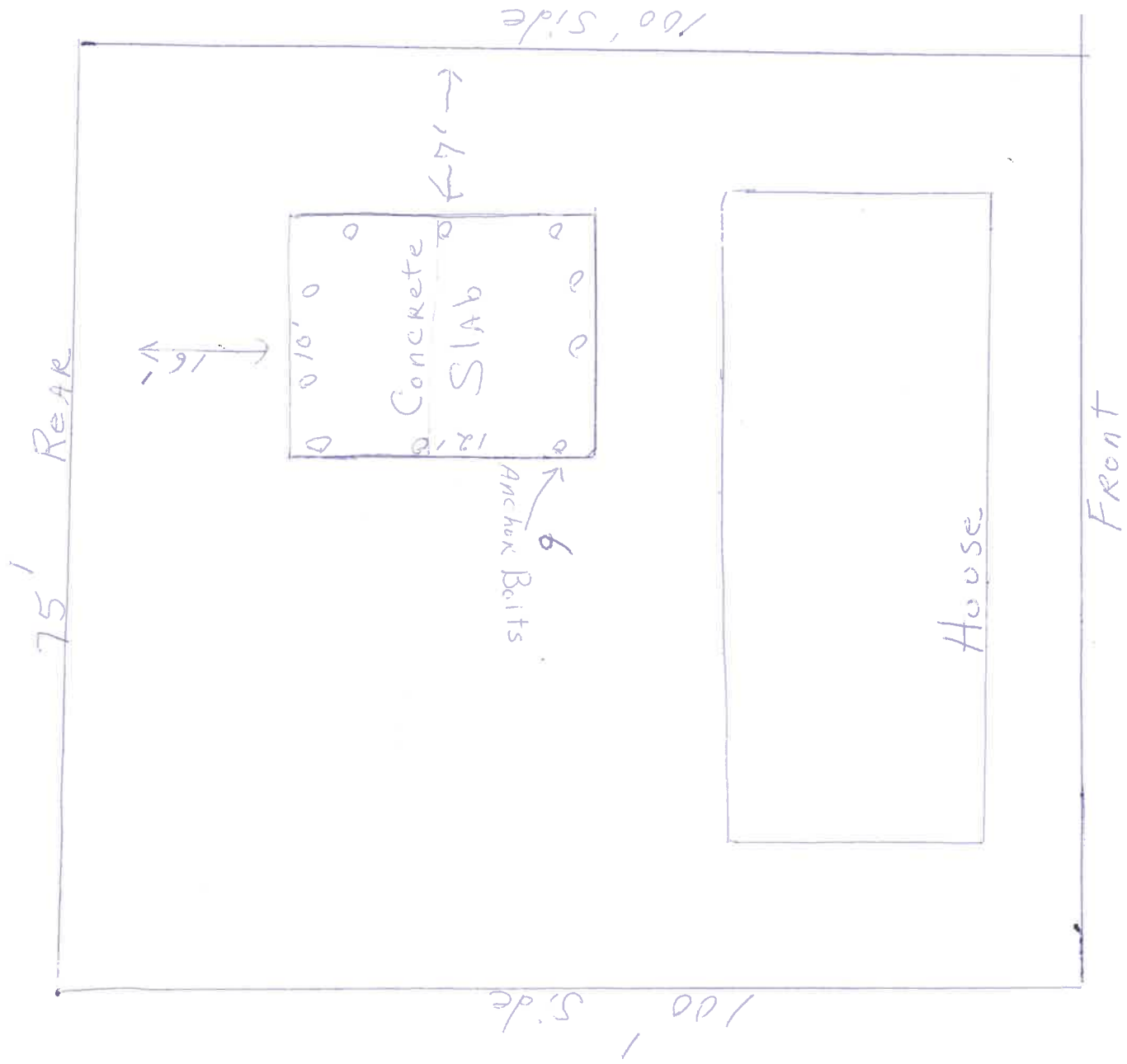

CITY OF NAPOLEON

ZONING PERMIT

Zoning Permit No. 510-76

Issued MAY 5, 1976

By [Signature] Zoning Inspector

Filing Fee	<u>None</u>	Amount	<u>---</u>
		Date Paid	<u>---</u>

Issued To: Richard Hatcher

Lot Information:

Street Address 1125 Sycamore Drive

Lot No. 31, 32, 33 Subdivision Malestic Heights

(or Legal Description)
CONFORM TO DIST. "A"

Lot Dimensions 75' x 100' Yard Set Back: Front 15' Rear 15'

Lot Area 7,500 Sq. Ft. Each Side 5' Total 15'

Zoning District "A" Description of Use Storage & Tool Shed 12' x 10'

Lot Coverage Max. 35% OK Off Street Parking Spaces Required Two (2) OK

Height Max. 18' Loading Spaces Required None

Petition or Appeal Required None

Approved By: Zoning Inspector Yes Board of Zoning Appeals ---

Date 5-5-76 Applicant Signature [Signature] Owner-Agent Gold - Board of Zoning Appeals

White - Applicant Yellow - Clerk-Treasurer Pink - Engineering

